

FLEXIBLE CORE CURRENT TRANSFORMERS

Window size 1.5, 2.5, 3.2, 4, 6 & 8".

Models 1.5FSH, 2.5FSH, 3FSH, 4FSH, 6FSH & 8FSH.

Standard 5-amp secondary.
Others available.

APPLICATION:
Ammeters, Wattmeters and Relays.

CONTINUOUS THERMAL RATING:
1.33 at 30 C. amb.; 1.0 at 55 C. amb. Average.

INSULATION CLASS:
0.6 kV. BIL 10kV. full wave. 50-400 Hz.

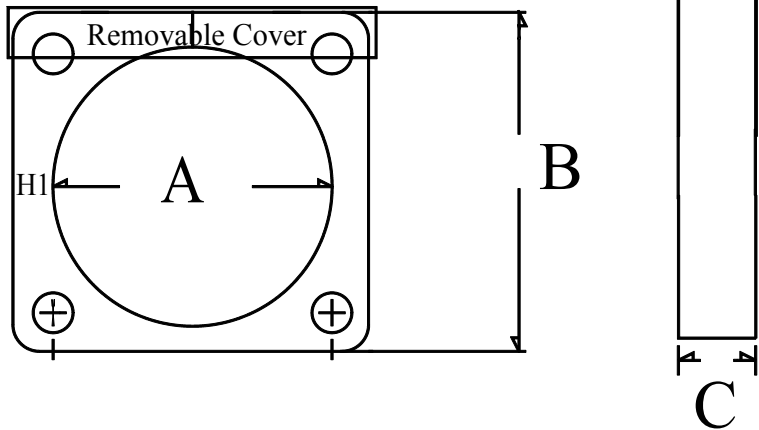
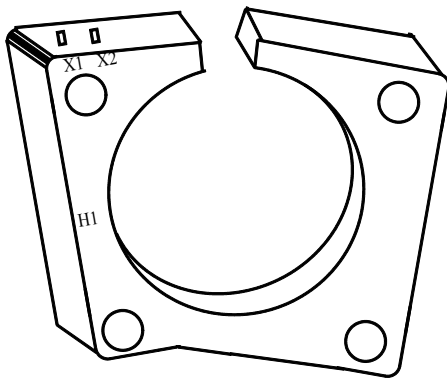
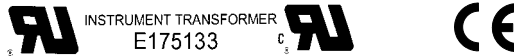

- Terminals are brass No. 10-32 UNC.
- All models:
Fully encapsulated.
Indoor/outdoor applications.
- Mounting brackets optional.
- Additional ratios available.

NOTE: Not recommended to flex more than 50% of opening.

DIMENSIONS

MODEL	A	B	C	Lbs.
1.5FSH	1.5	3.75	1.50	1.0
2.5FSH	2.5	4.75	1.50	1.0
3FSH	3.2	6.0	1.50	2.0
4FSH	4.2	6.0	1.50	2.0
6FSH	6.6	9.2	2.0	5.5
8FSH	8.6	11.0	2.0	7.5

Suggested Ratio to Size

- MOD. 1.5FSH 250 to 300A
- MOD. 2.5FSH 250 to 600A
- MOD. 3FSH 250 to 800A
- MOD. 4FSH 400 to 1000A
- MOD. 6FSH 600 to 4000A
- MOD. 8FSH 600 to 6000A

CATALOG NUMBER	CURRENT RATIO	ANSI METERING CLASS AT 60 Hz				VA @ +/-1%
		B0.05	B0.1	B0.2	B0.5	
**200	200:5	1.5	3.0	-	-	
**250	250:5	1.0	2.4	-	-	5.0
**300	300:5	1.0	2.4	4.0	-	7.5
**400	400:5	0.8	2.0	2.8	-	10.0
**500	500:5	0.8	2.0	2.8	-	12.5
**600	600:5	0.6	1.2	2.4	-	15.0
**800	800:5	0.6	1.2	2.4	-	20.0
**1000	1000:5	0.6	0.6	1.2	2.4	30.0
**1200	1200:5	0.6	0.6	1.2	2.4	30.0
**1500	1500:5	0.6	0.6	1.2	1.2	35.0
**1600	1600:5	0.6	0.6	0.6	1.2	35.0
**2000	2000:5	0.6	0.6	0.6	1.2	50.0
**2400	2400:5	0.6	0.6	0.6	0.6	50.0
**2500	2500:5	0.6	0.6	0.6	0.6	75.0
**3000	3000:5	0.6	0.6	0.6	0.6	75.0
**3500	3500:5	0.6	0.6	0.6	0.6	75.0
**4000	4000:5	0.6	0.6	0.6	0.6	75.0
**5000	5000:5	0.6	0.6	0.6	0.6	50.0
**6000	6000:5	0.6	0.6	0.6	0.6	50.0

Made in the United States of America

Aug. 2011

